

SILBERRAD STUDENT CENTRE



University of Essex

Welcome to Colchester Campus

Say hello to our Colchester Campus reception team. Ask them about tours of the campus, to help you find your feet.

Opening hours: 8.45am to 5pm, Monday to Friday

T 4321

E recept@essex.ac.uk

Learning Hub

Got a piece of work you really need to get your teeth into? The Learning Hub has all you need. From special study pods to flexible learning space; find inspiration at any time – it's open 24/7.

IT Helpdesk

Having trouble with your computer? Come to the IT Helpdesk, your first point of contact for student and staff IT queries.

Opening hours: 8.30am to 6pm Monday to Thursday;
Friday 8.30am to 5.45pm

T 2345

E desk@essex.ac.uk

Talent Development Helpdesk

Unleash your true potential with help from our expert talent and skills advisers. Talk to them about:

- Academic literacy
- English language
- Numeracy, maths and statistics, working with the Maths Support Centre
- Study skills

Need a one-to-one session?

Book one, or just drop-in.

Opening hours: 10am to 4pm Monday to Friday

T 4834

E tdc-helpdesk@essex.ac.uk

Students' Union Creative Studios

Want to learn to create professional content in the digital world? Look no further.

Our Creative Studios bring together all forms of creativity at Essex, from design and photography to journalism, radio and TV. Our studios give you access to top of the range equipment and software, as well as workshops, tutorials and training sessions.

Student Services Hub

Studying at Essex is a unique living and learning opportunity, but where can you go for practical advice, information and guidance when you need it?

Our Student Services Hub gives you one place to go for the information you need. Want to know how and when to apply for accommodation? Just ask us. Having problems with your funding? We're here to help. Struggling with exam stress? We're listening. Your question matters and you'll get answers from experts.

If you want to visit us, we're on the first floor of the Silberrad Student Centre. You'll find our helpful staff at our Information Desk, while a separate Support Desk and meeting spaces offer privacy when you need it.

Our expert teams are also ready to take your questions by email or phone. Drop us a line or pay us a visit, you'll always be welcomed and listened to, and sometimes that's all you need.

Ask the hub about:

- Accommodation
- Course administration
- Disability services
- Exams and coursework
- Health and wellbeing
- International student advice
- Money matters and funding
- Official documents
- Rent and fee payments

Opening hours:

9am to 5pm, Monday to Friday

T 4000

E askthehub@essex.ac.uk

SECOND FLOOR

Reading Room

Need somewhere quiet to focus on your work? The Reading Room is just the place. Take your books and your thoughts and enjoy this space anytime, its open 24/7.

Lakeview Room

The Lakeview Room (SSC.2.12) overlooks our spectacular lakes and is a great place to hold a special event or important meeting. If you want to use the terrace, make sure to mention it when you book the space via our Central Timetabling Office.

GROUND FLOOR

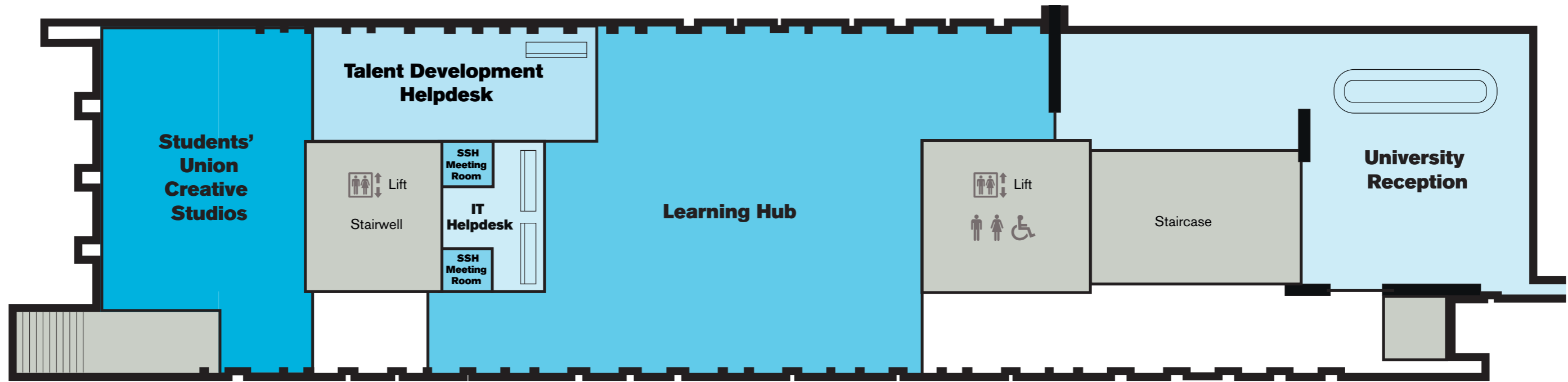

FIRST FLOOR

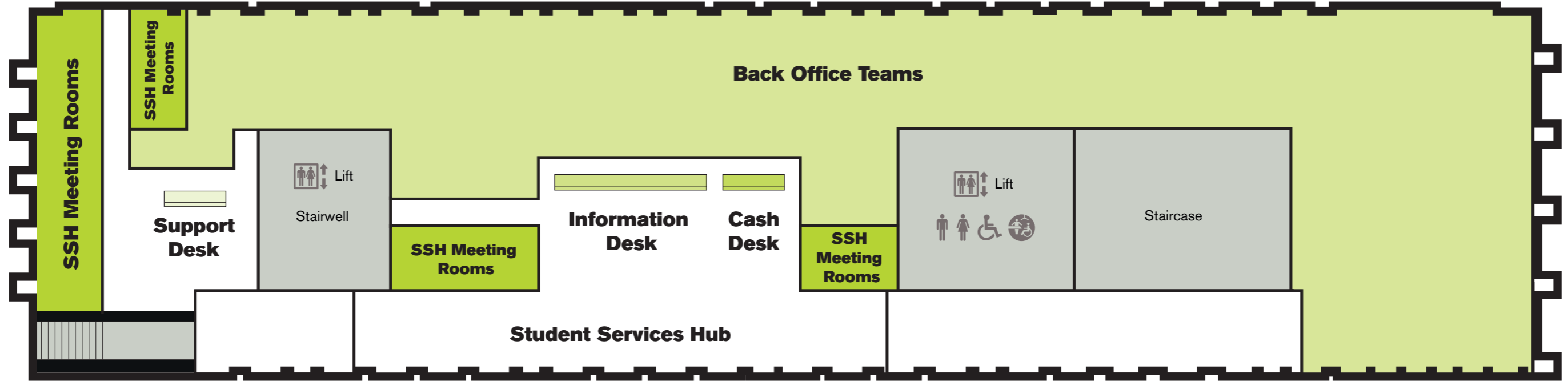

SSH meeting rooms are used for confidential student appointments.

SECOND FLOOR

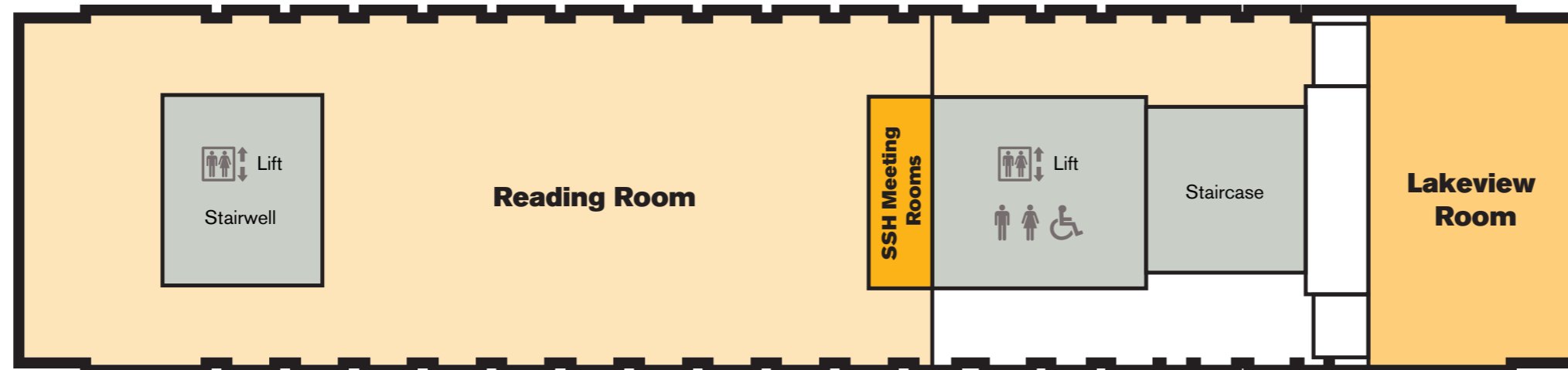

Our Silberrad Student Centre is home to everything a student may need, from study space to student services and IT to Talent Development and the Students' Union.

When is the Silberrad Student Centre open?

The Silberrad Student Centre is open 24 hours a day, seven days a week.